

Conference Rooms, Boardrooms and Break Out Room
 Are Located on the 1st Floor
 270 Flinders Street, Melbourne

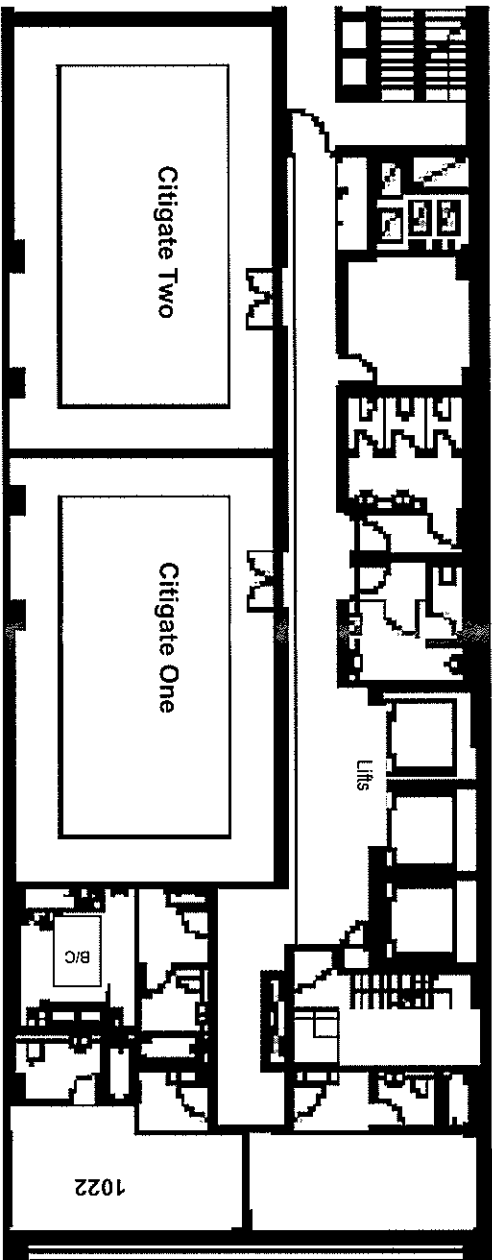

Citigate One is the same size as Citigate Two @ 10.77mts long & 6.57mtes wide
 (70.76mtr sq) & (233.5 sq ft)

When opened into one large room it becomes 21.54mtrs long & 6.57mtrs wide
 (141.52 mtr sq) & (467 sq ft)
 The height of the room is 2.53 mtr

Citigate One & Two Separate Citigate One & Two Together

- | | |
|--------------------|--------------------|
| Cabaret – 24 pax | Cabaret – 60 pax |
| Theatre – 60 pax | Theatre – 150 pax |
| Classroom – 25 pax | Classroom – 56 pax |
| Cocktail – 70 pax | Cocktail – 180pax |
| U-Shape – 24 pax | U-Shape – 56 pax |
| Boardroom – 25 pax | Boardroom – 62 pax |
| Dining – 50 pax | Dining – 100 pax |